

**LOAD-DEFLECTION CURVE**

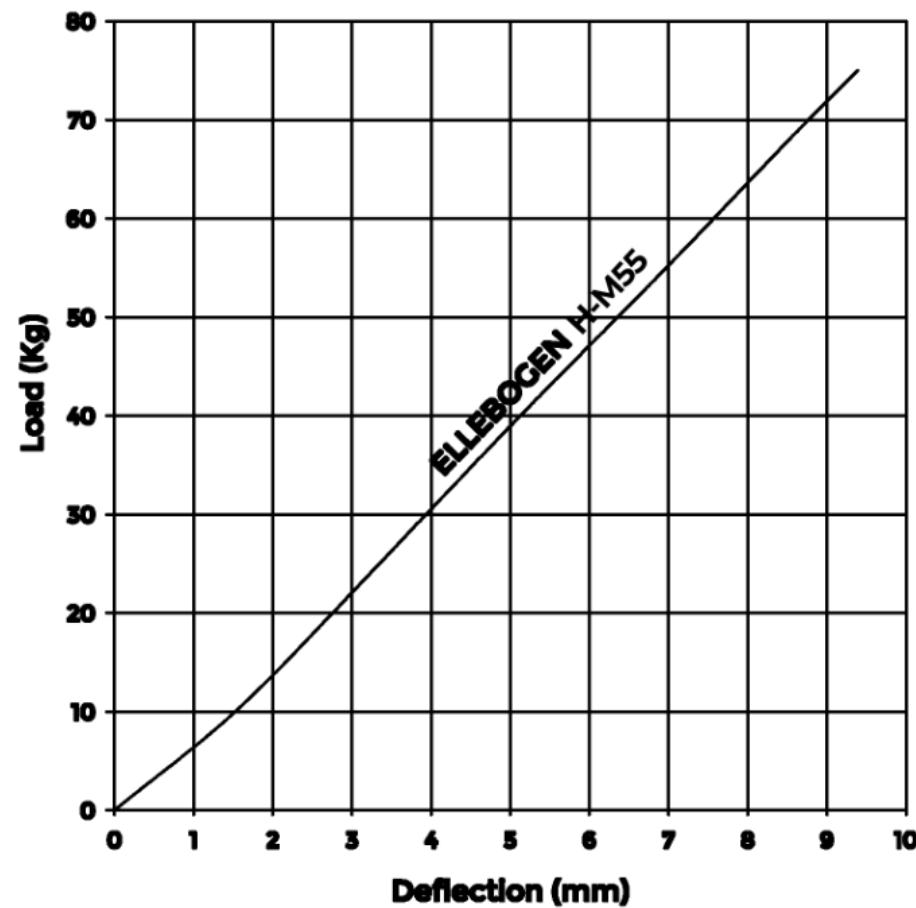

**NATURAL FREQUENCY CURVE**

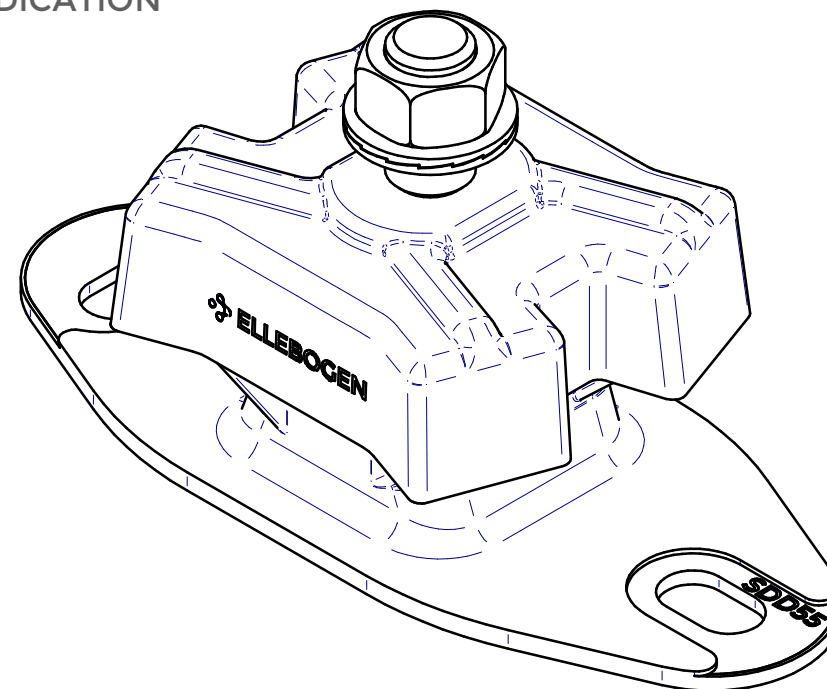
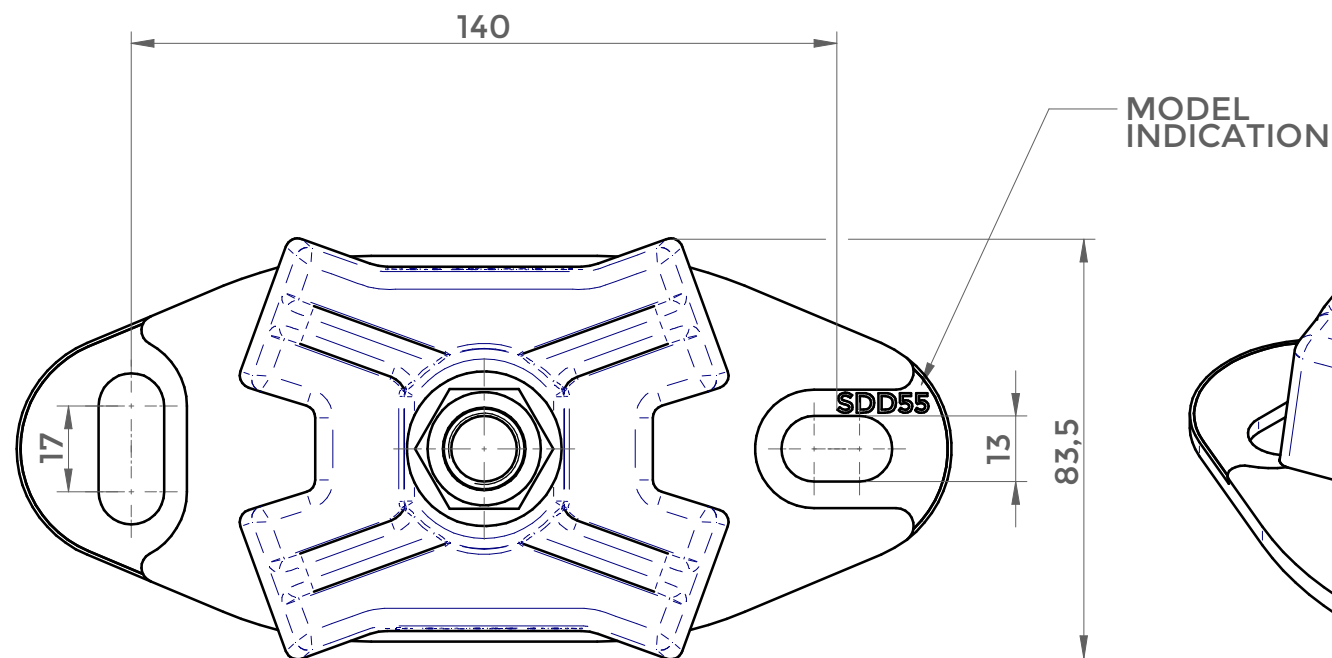
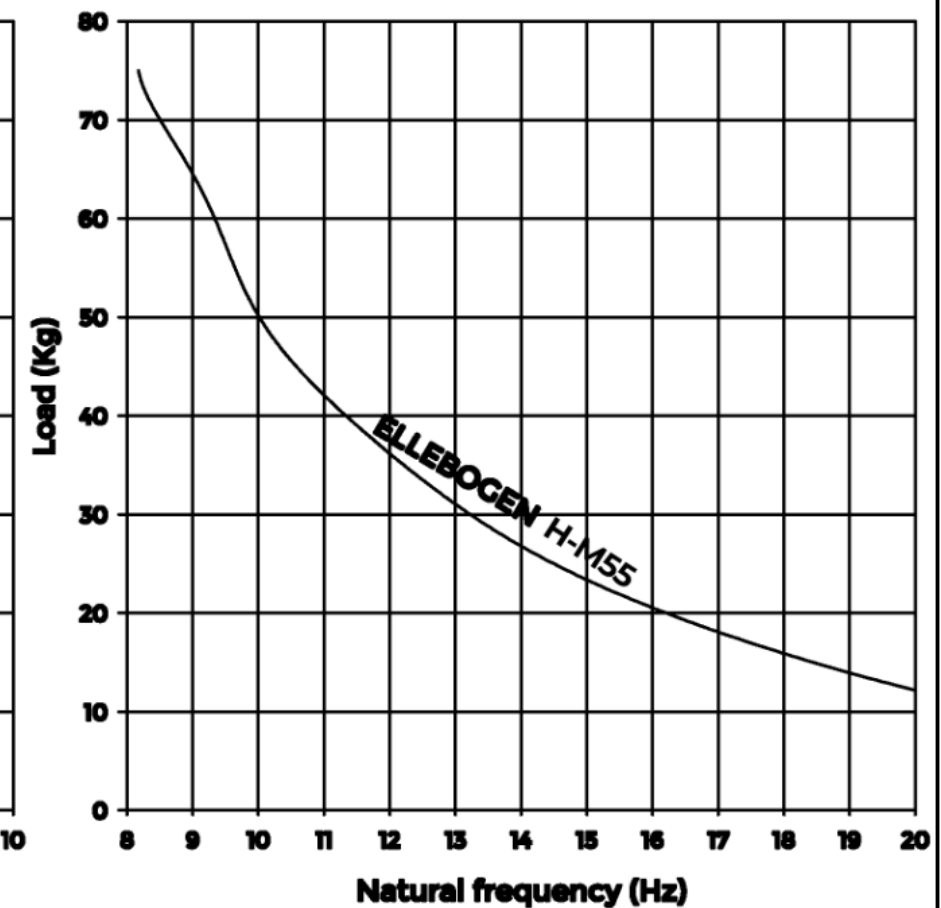

**RECOMMENDED TIGHTENING TORQUE FOR DIN 934 NUTS:**

190 ~ 240 Nm  
19 ~ 24 kgf·m  
137 ~ 174 ft·lbs



**ELLEBOGEN**

PROJECTION:

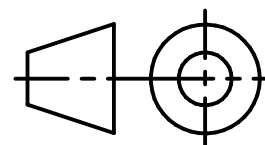

DESCRIPTION:

ELLEBOGEN H-M55 MARINE ENGINE MOUNT

REF. NO.:

128450-01550

ESTIMATED WEIGHT:

0,713kg

REV.:

00

DRAWN:

R. E.

APPROVED:

I. J.

DATE:

12/05/2025

DATE:

12/05/2025

SCALE:

1:1,5

SHEET SIZE:

**A3**

GENERAL TOLERANCES ACC. TO ISO 2768-C

OVER (mm)	0,5	3	6	30	120	400	1000
UP TO (mm)	3	6	30	120	400	1000	2000
TOL. (mm)	±0,2	±0,3	±0,5	±0,8	±1,2	±2	±3

RUBBER TOLERANCES ACC. TO ISO 3302-M3

THIS DOCUMENT IS TO BE TREATED AS STRICTLY PRIVATE AND CONFIDENTIAL.

IT SHALL NOT BE DISCLOSED TO THIRD PARTIES WITHOUT PRIOR WRITTEN CONSENT.