

RECOMMENDED TIGHTENING TORQUE FOR DIN 934 NUTS:

380 ~ 470 Nm  
 38 ~ 47 kgf·m  
 280 ~ 345 ft·lbs

RECOMMENDED TIGHTENING TORQUE FOR DIN 936 NUTS (THIN NUTS):

70 Nm  
 7 kgf·m  
 52 ft·lbs



**ELLEBOGEN**

PROJECTION:

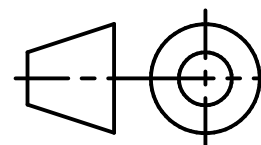

DESCRIPTION:

ELLEBOGEN GT-M45 M20 MARINE ENGINE MOUNT

REF. NO.:

120650-08101

ESTIMATED WEIGHT:

1,588kg

REV.:

02

DRAWN:

R. E.

APPROVED:

I. J.

DATE:

12/03/2026

DATE:

12/03/2026

SCALE:

1:2

SHEET SIZE:

A3

GENERAL TOLERANCES ACC. TO ISO 2768-C

OVER (mm)	0,5	3	6	30	120	400	1000
UP TO (mm)	3	6	30	120	400	1000	2000
TOL. (mm)	±0,2	±0,3	±0,5	±0,8	±1,2	±2	±3

RUBBER TOLERANCES ACC. TO ISO 3302-M3

THIS DOCUMENT IS TO BE TREATED AS STRICTLY PRIVATE AND CONFIDENTIAL.

IT SHALL NOT BE DISCLOSED TO THIRD PARTIES WITHOUT PRIOR WRITTEN CONSENT.